

Smart Contact Sensor

User Guide

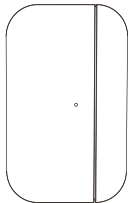

I. Brief Introduction

Thank you for choosing this smart contact sensor. The sensor supports real-time viewing of the opening/closing status of doors/windows, and the APP will instantly push alarm information to let you know the situation at the first time.

Notice:

- Please turn on Bluetooth on your Phone
- Only supports 2.4Ghz WiFi network

II. Appearance Design

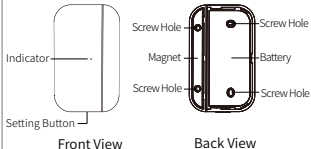

III. Indicator

Light Status	Sensor Status
Blink quickly	WiFi connection configuration
Blink once	Door Open/Close

IV. Set up Smart Life APP

4.1 Download APP -Smart Life



Apple APP Store



Google Play Store

1. iOS users, please scan the Apple APP QR code.
2. Android users, please scan the QR code of Google Play to download.

4.2 Connect Sensor to Smart Life APP

1. Press and hold the bottom setting button for **3 seconds**, the red light flashes quickly, and the sensor is waiting for pairing.

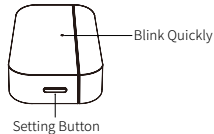

2. On the APP: Open the "Smart Life" APP and enter the "Home" interface.
 - A. Click the "+" on the upper right corner of the interface and select "Add Device".

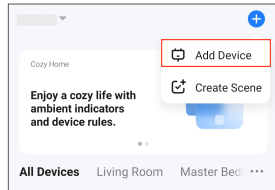

- B. Press "Add" on the discovering device's area.

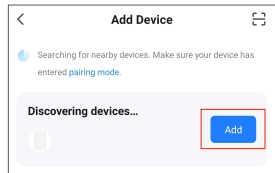

C. Input the 2.4Ghz WiFi name and password, and click "Next".

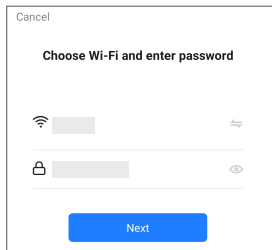

D. Then press "+".

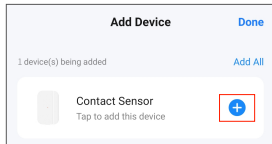

E. Paired successfully

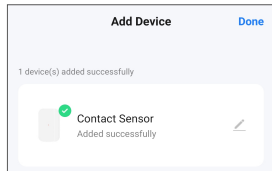

F. Main Interface

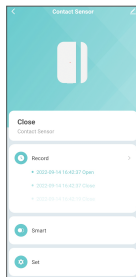

V. Installation

The Contact sensor should be installed on the door or window (see image).

1. First, wipe the area on the door and window clean and apply double-sided tape to the bottom, or secure with screws.
2. The door sensor transmitter (large) and the door sensor magnet (small) should be installed separately. The distance between the two parts is less than 0.7".

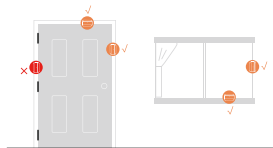

VI. Replace the Battery

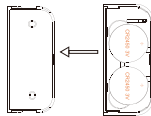

Slide in the direction of the arrow to remove the back cover

VII. Specification

Battery Specification	CR2450×2
Standby Current	≤10μA
Alarm Current	≤80mA
Working Temperature	-10°C~+50°C
Relative Humidity	<95%
WiFi Standard	2.4GHz
Product Size	70×31.5×15.5mm (Large) 70×11×13.5mm (Small)

